

### Main characteristics

B040 is an electronic proximity switch based on photoelectric principle of revealing light beam interruption caused by the passage of an object. It's available in trough-been version, made up by two photoelectric bars, one in front of the other, the emitter and the receiver. The switching command is initiated by a body or object penetrating into the monitoring field.



Light grids

### Ordering code

<b>B</b>	<b>0</b>	<b>40</b>	<b>H</b>	<b>120</b>	<b>C</b>	<b>12</b>	<b>N</b>	<b>3</b>	<b>W</b>
light grid <b>B</b>	photoelectric <b>0</b>	Beam spacing 40 mm <b>40</b>	Scanning height (mm) 120/280/360/440/600/760/920 1240/1560/1880/2200/2520	Output configuration NC <b>C</b>	Max power supply 12 Vdc <b>12</b>	Electronic output NPN open collector <b>N</b>	Working distance 3 m max <b>3</b>	Output type cable <b>W</b>	

### Mechanical dimensions

dimensions: mm

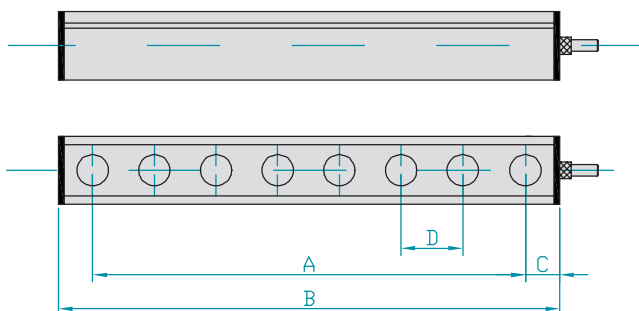

B040

## Mounting brackets

dimensions: mm

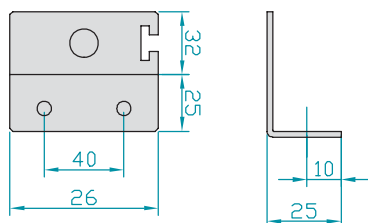

## Technical specifications

<b>Version</b>	trough-beam
<b>Number of beams</b>	4/6/8/10/12/16/20 24/32/40/56/64
<b>Scanning height</b>	120/280/360/440 600/760/920/1240/1560 1880/2200/2520 mm
<b>Beam spacing</b>	40 mm
<b>Output type</b>	cable
<b>Output electronic</b>	NPN open collector
<b>Output configuration</b>	NC
<b>Working distance</b>	3 m max
<b>Power supply</b>	12 Vdc $\pm 10\%$
<b>Voltage drop</b>	1,6 V max
<b>Maximum current without load</b>	100 mA max
<b>Maximum current with load</b>	100 mA max
<b>Protection class</b>	IP54
<b>Working temperature</b>	-10÷55 °C
<b>Working environment humidity</b>	35÷85% RH
<b>Light source</b>	infrared LED
<b>Standard object detected</b>	opaque, $\varnothing$ 50 mm min
<b>Response time</b>	20 ms max
<b>Ambient light intensity</b>	10000 lx max (sun light) 3000 lx max (artificial light)
<b>Vibrations</b>	10÷55 Hz
<b>Shock rating</b>	50 G
<b>Housing material</b>	aluminium
<b>Frontal material cover</b>	PMMA
<b>Protection against polarity inversion</b>	yes

Light grids

## Electrical connections

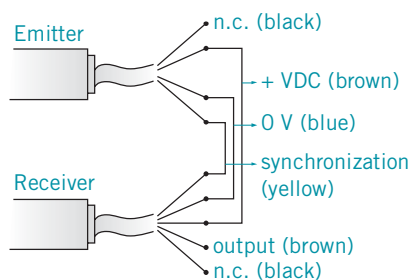

## Mechanical data

Model	A (mm)	B (mm)	C (mm)	D (mm)
<b>B040H120</b>	120	180	30	40
<b>B040H280</b>	200	260	30	40
<b>B040H360</b>	280	340	30	40
<b>B040H440</b>	360	420	30	40
<b>B040H600</b>	440	500	30	40
<b>B040H760</b>	600	660	30	40
<b>B040H920</b>	760	820	30	40
<b>B040H1240</b>	920	980	30	40
<b>B040H1560</b>	1240	1300	30	40
<b>B040H1880</b>	1560	1620	30	40
<b>B040H2200</b>	2200	2260	30	40
<b>B040H2520</b>	2520	2580	30	40

B040



www.eltra.it e-mail: eltra@eltra.it

Via Monticello di Fara, 32 bis - 36040 Sarego (VI) - ITALY - Tel. +39 0444 436489 R.A. - Fax. +39 0444 835335  
 © Copyright 2006 Eltra S.p.a. - All right reserved: All information in this catalog is subject to change without notice - Eltra takes no responsibility for typographical errors.  
 For the terms of sales please check the website www.eltra.it.